

ARABELLA



CALIBRAREA CPAP

CALIBRAREA SENZORULUI DE OXIGEN

1. Convingeți-vă că dispozitivul este conectat la sursa de oxigen și aer și este conectat
2. Reglați fluxul la 8L/min
3. Setati concentrația de oxigen la 21% de la reglator. Așteptăm un minut. Comparăm valoarea setată cu cea măsurată. Dacă există careva divergențe, o calibram la 21%
4. Setăm concentrația de oxigen la 100% de la reglator. Așteptăm un minut. Comparăm valoarea setată cu cea măsurată. Dacă exista careva divergențe, o calibram la 100%

CALIBRAREA SENZORULUI DE PRESIUNE

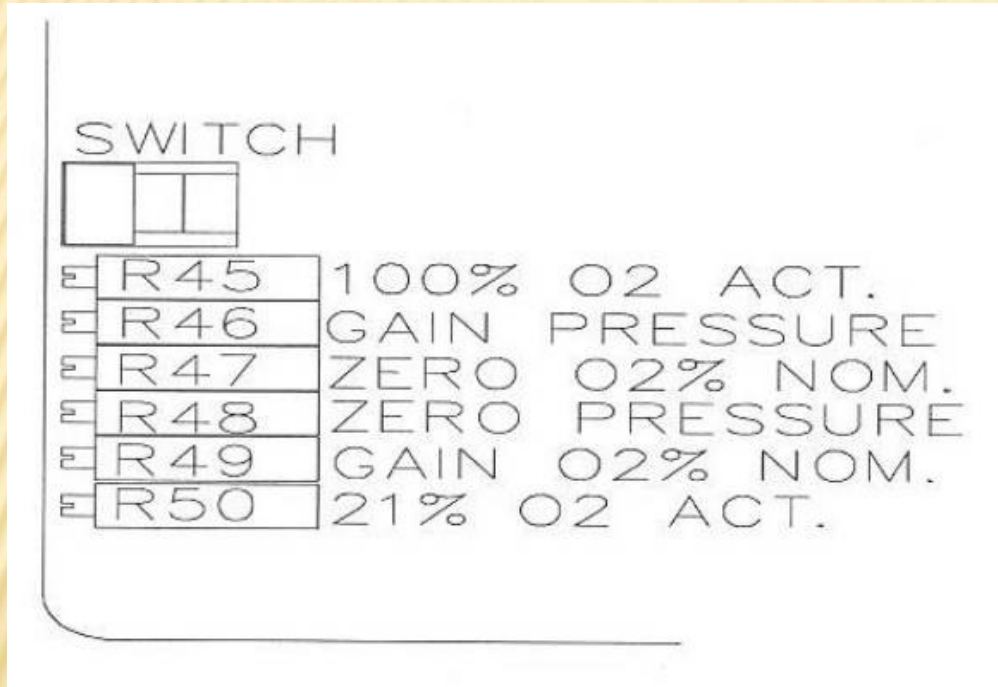

Calibrarea = etalon

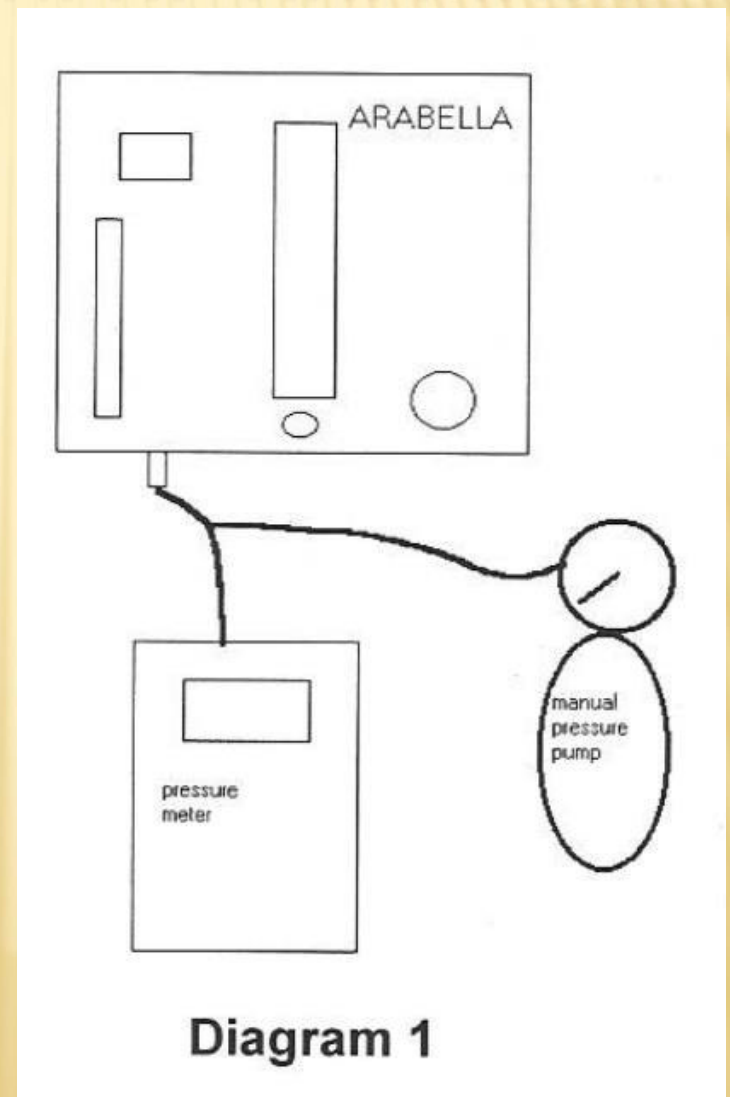

VERIFICAREA DISPOZITIVULUI

- ✘ Verificarea acuratetei senzorului de presiune
- ✘ Verificarea fluxului si presiunii

6 LPM => **3 cmH₂O**
7 LPM => **4 cmH₂O**
8 LPM => **5 cmH₂O**
9 LPM => **6 cmH₂O**
10 LPM => **7 cmH₂O**

Remove prongs and verify the manometer drops to **0 cmH₂O**.

TESTUL DE PRESIUNE

- ✘ Reglăm fluxmetrul până la 8L/min
- ✘ Blocăm ieșirea generatorului și ne uităm dacă presiunea se ridică la 5 cmH₂O
- ✘ Ridicăm fluxul până la 11 L/min ne uităm dacă presiunea a căzut la 0 și se aude un sunet (este sunetul valvei de siguranță)

In caz ca nu trece testul nu utilizați in continuare dispozitivul !!!

BUBBLE CPAP

- ✘ Sistemul Bubble CPAP combina efectul CPAP cu presiunea oscilatorie generate de bulele de apa, oferind un tratament protector pentru plamani, sigur si economic, disponibil ca metoda de suport respirator al nou-nascutilor cu respiratie spontana.

Nasal bubble CPAP

Simple Bubble CPAP Setup and Components

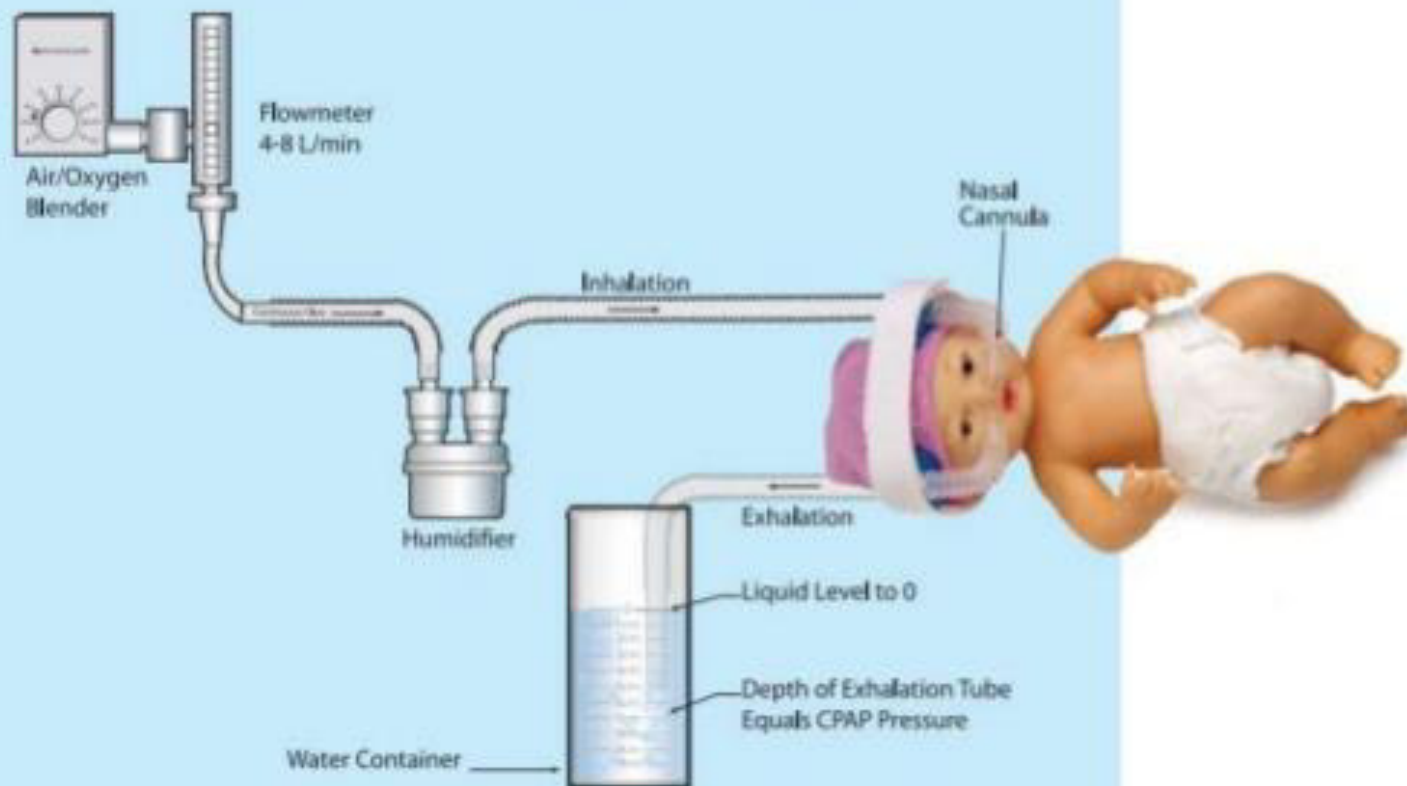

BUBBLE CPAP

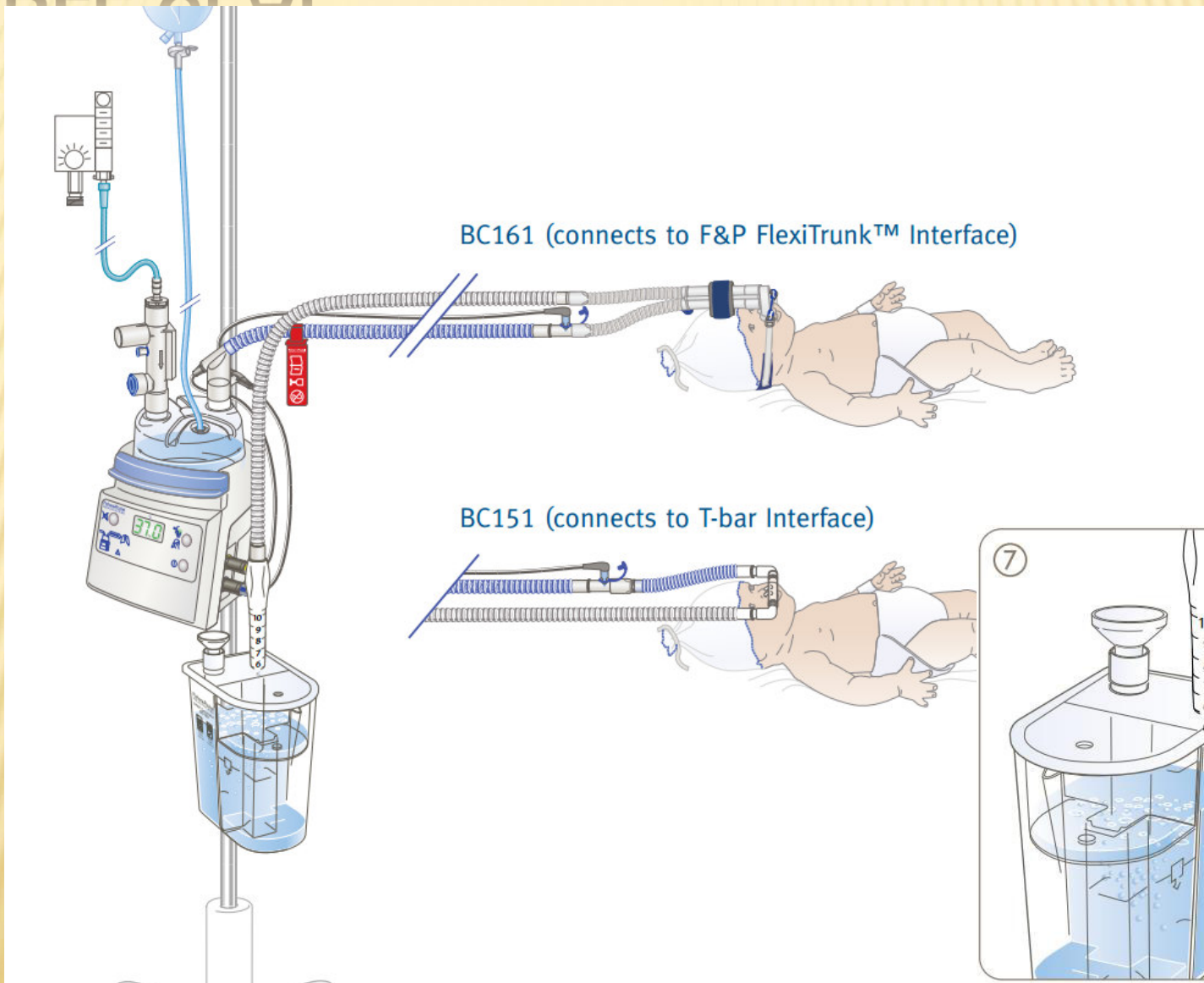

PRESSURE-FLOW TABLE - F&P Bubble CPAP Generator used with F&P Infant Interface, typical mean pressure values (cmH₂O) WITH NO LEAK

PROBE SETTING (cmH₂O)

Flow (L/min)	3	4	5	6	7	8	9	10
4	3.1	4.1	5.1	6.1	7.1	8.1	9.1	10.0
5	3.2	4.2	5.3	6.3	7.3	8.3	9.2	10.1
6	3.4	4.4	5.4	6.4	7.4	8.4	9.3	10.2
7	3.6	4.6	5.6	6.6	7.6	8.5	9.5	10.4
8	3.8	4.8	5.8	6.8	7.8	8.7	9.6	10.5
9	4.0	5.0	6.0	7.0	7.9	8.9	9.8	10.6
10	4.3	5.3	6.2	7.2	8.1	9.0	9.9	10.8
11	4.6	5.6	6.5	7.4	8.4	9.2	10.1	10.9
12	4.9	5.8	6.8	7.7	8.5	9.4	10.2	11.1
13	5.2	6.1	7.0	7.9	8.8	9.6	10.4	11.3
14	5.5	6.4	7.3	8.2	9.0	9.8	10.6	11.4
15	5.8	6.7	7.5	8.4	9.2	10.0	10.8	11.6

UTILIZARE CPAP IN COMBINATIE CU BUBBLE

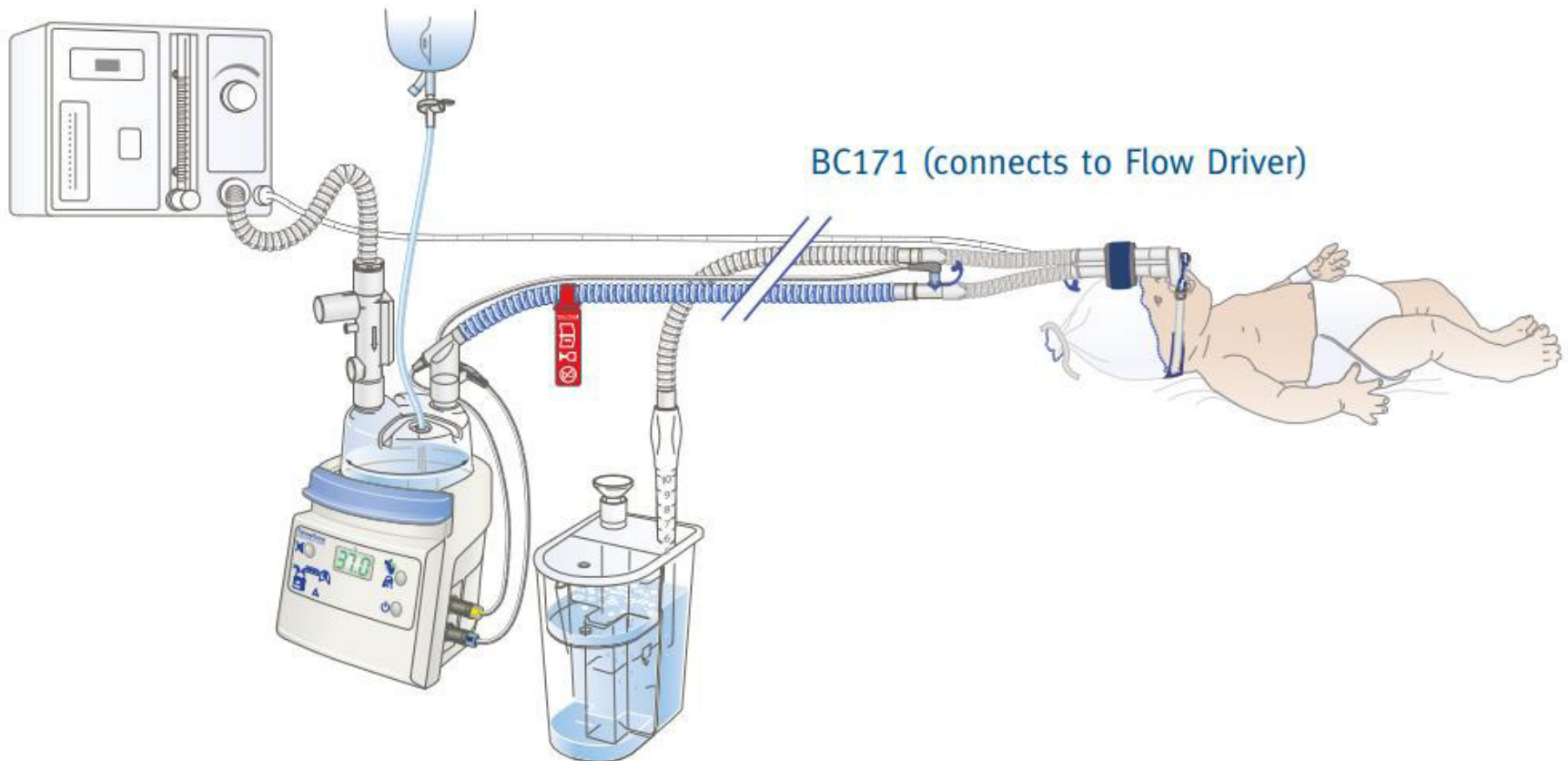



9. Set the Humidifier (MR850)



Ensure there is air flow present before turning on the humidifier.

- Turn on the flow driver.
- Turn on the humidifier.
 - If using the MR850, ensure it is on Invasive mode (37 °C).
- Refer to the MR850 User Instructions for further information.



9A. Set the Humidifier (MR730)



Ensure there is air flow present before turning on the humidifier.

- Turn on the flow driver.
- Turn on the humidifier.
 - If using the MR730, set the temperature to 40 °C, -3.
- Refer to the MR730 User Instructions for further information.

CPAP HIGH FLOW AIRV02

- ✘ Produce un flux majorat de la 2-60 L/min în dependență de circuitul utilizat:pediatric, adult

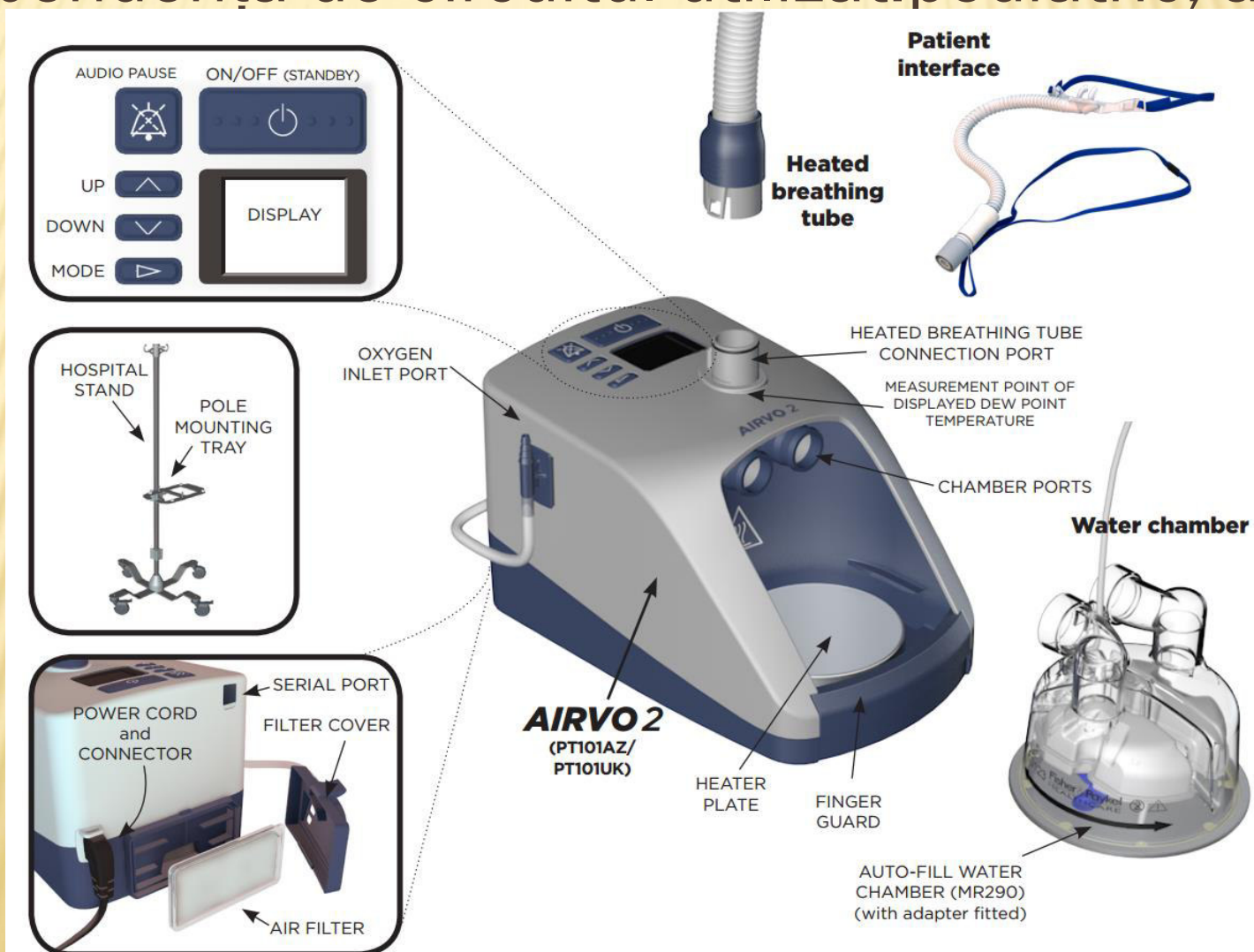

INSTALAREA CAMEREI DE UMIDIFICARE

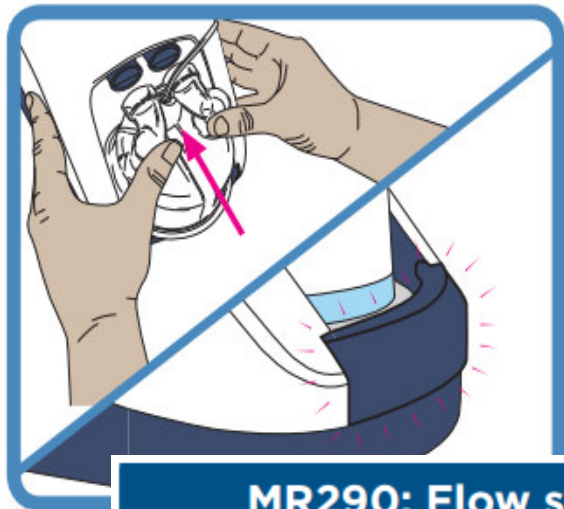
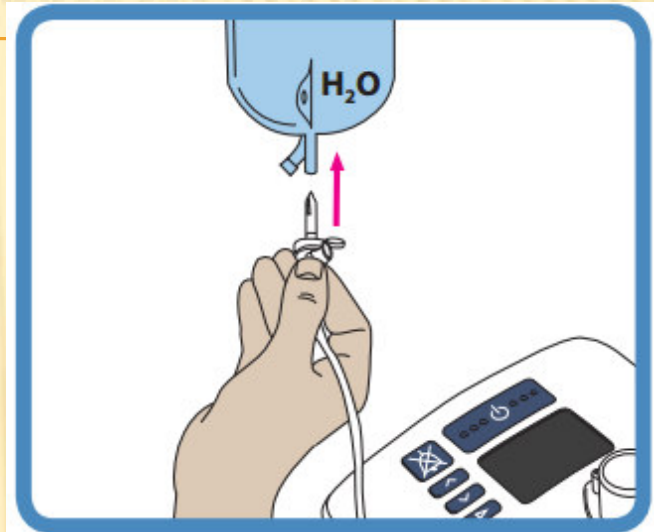
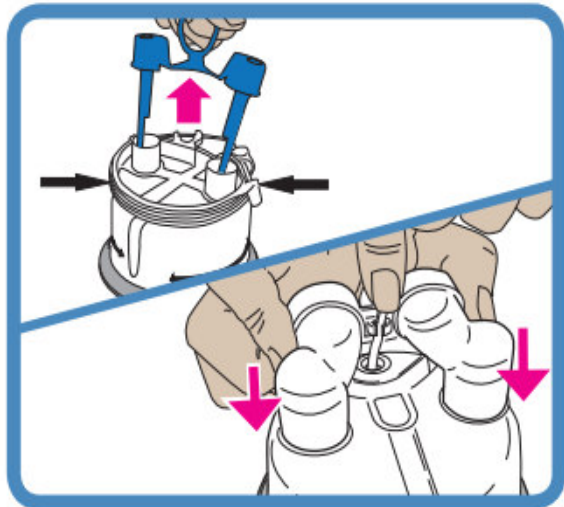

MR290: Flow setting vs usage time (2-litre sterile water bag)

L/min	2	5	10	15	20	25	30	35	40	45	50	55	60
hrs	379	152	76	51	38	30	25	22	19	17	15	14	13

INSTALAREA TUBULUI CU ÎNCĂLZIRE

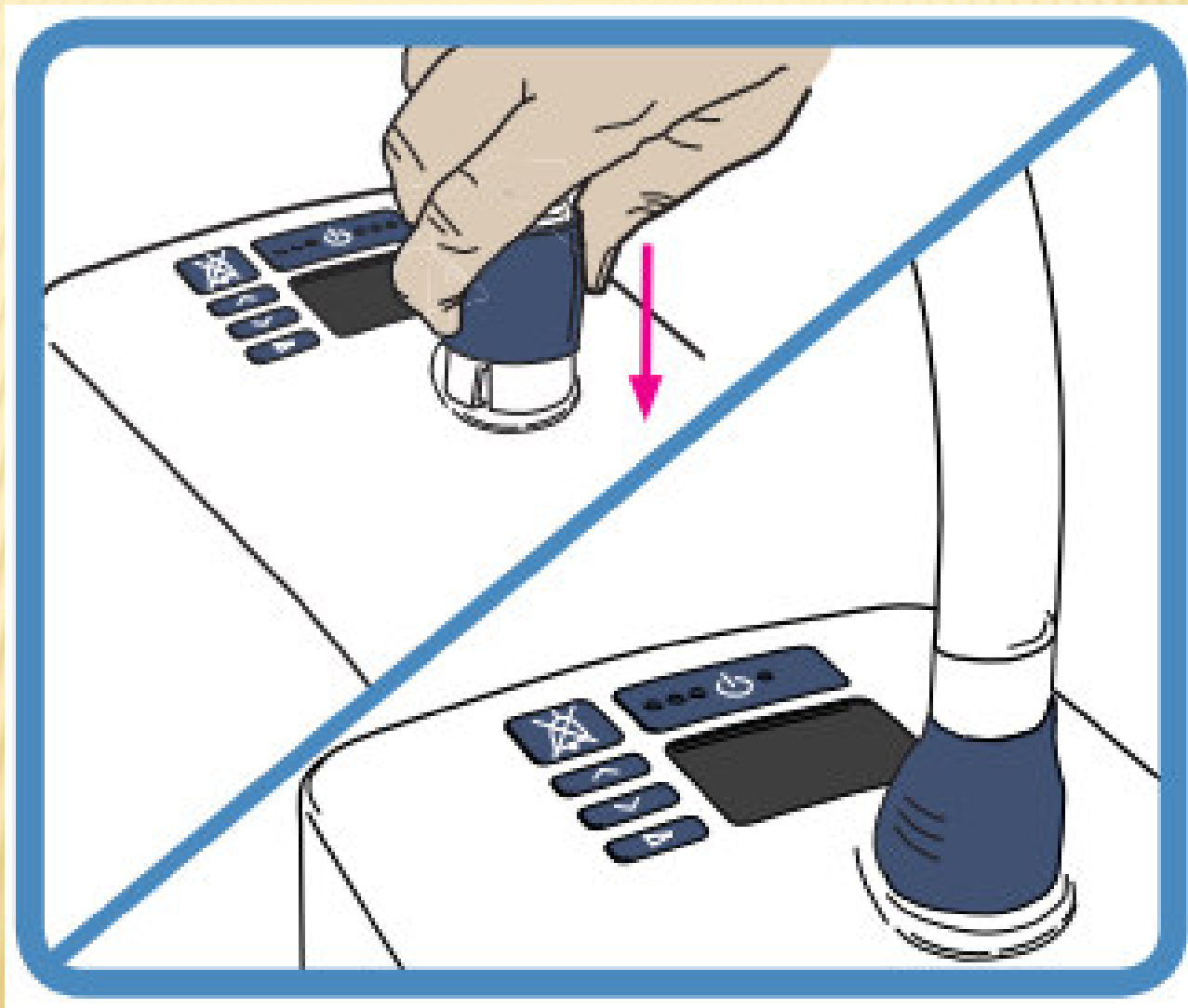

ALEGEM INTERFAȚA PENTRU PACIENT

Nasal cannula

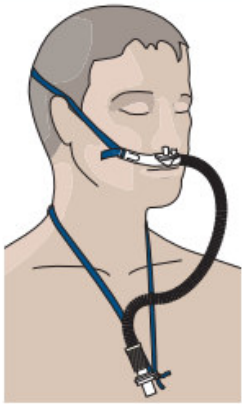

OPT842
OPT844
OPT846

Tracheostomy interface

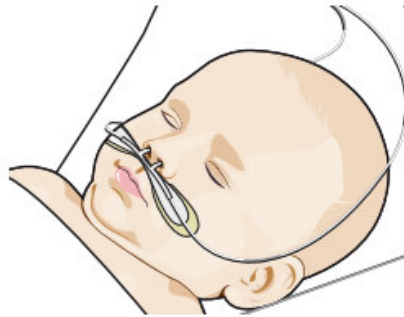

OPT316, OPT318
(Refer to "Using AIRVO 2" -
"Junior Mode")

Mask interface adapter

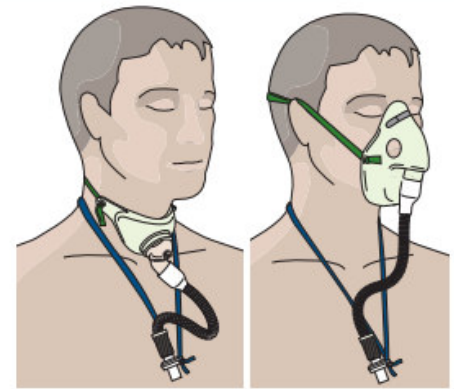

RT013 (with mask)
Note that the RT013 Mask Interface Adapter
is designed to be used with vented masks
only. Do not use sealed masks.

OPT870

SETAREA DISPOZITIVULUI

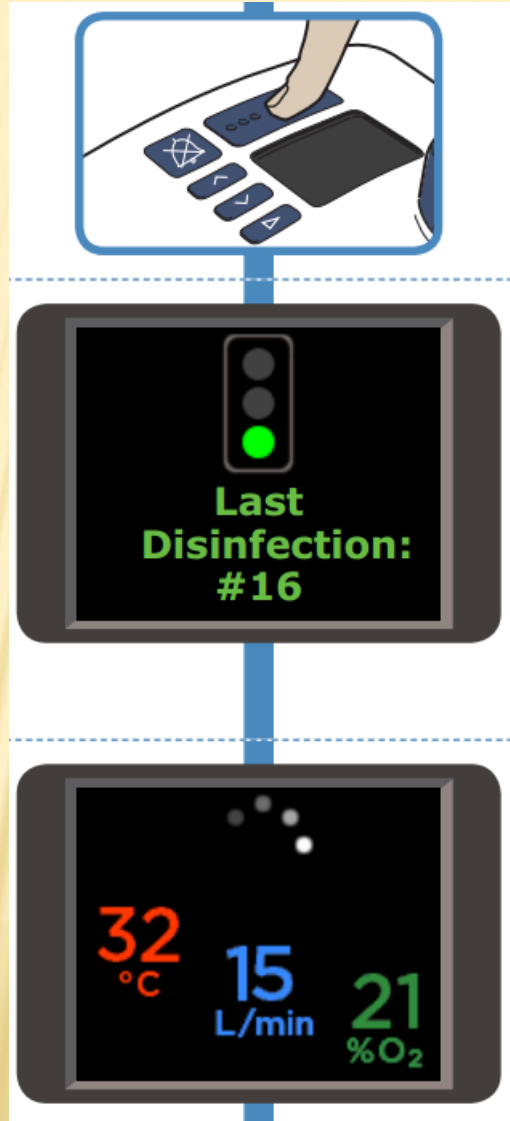

ALTE TIPURI DE DISPOZITIVE

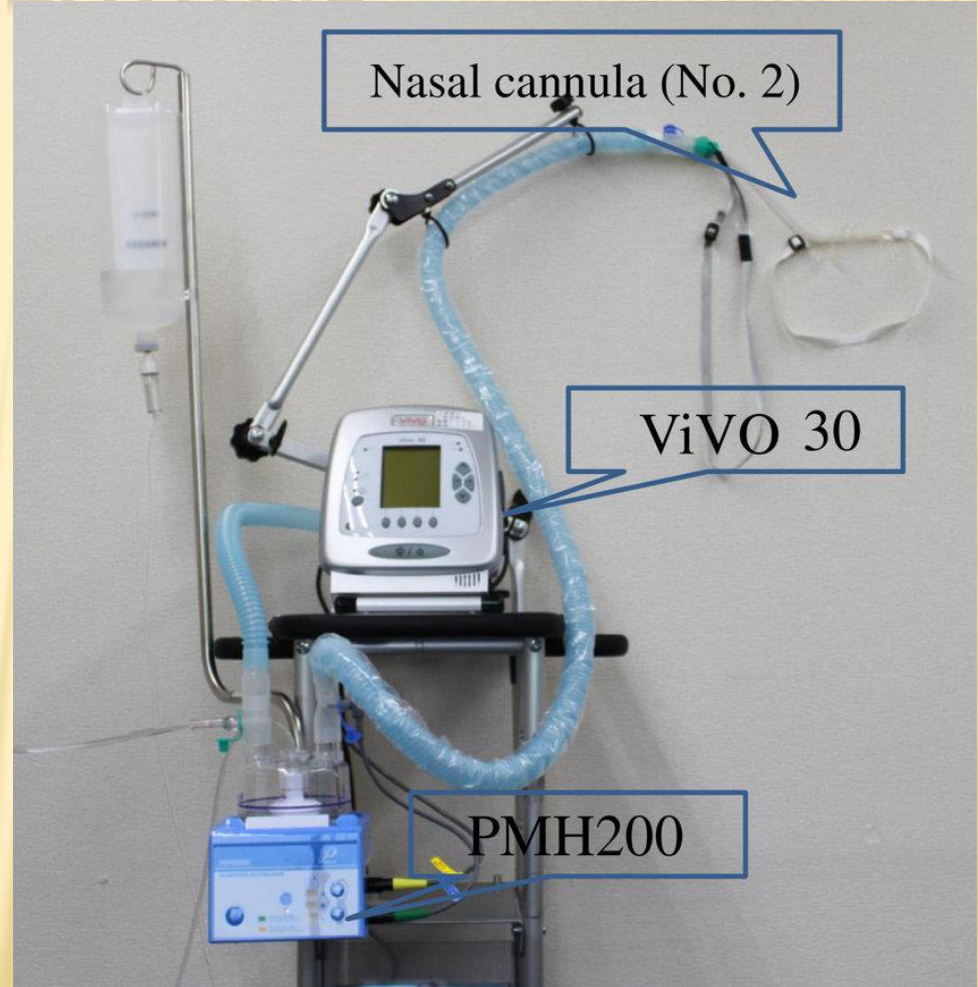
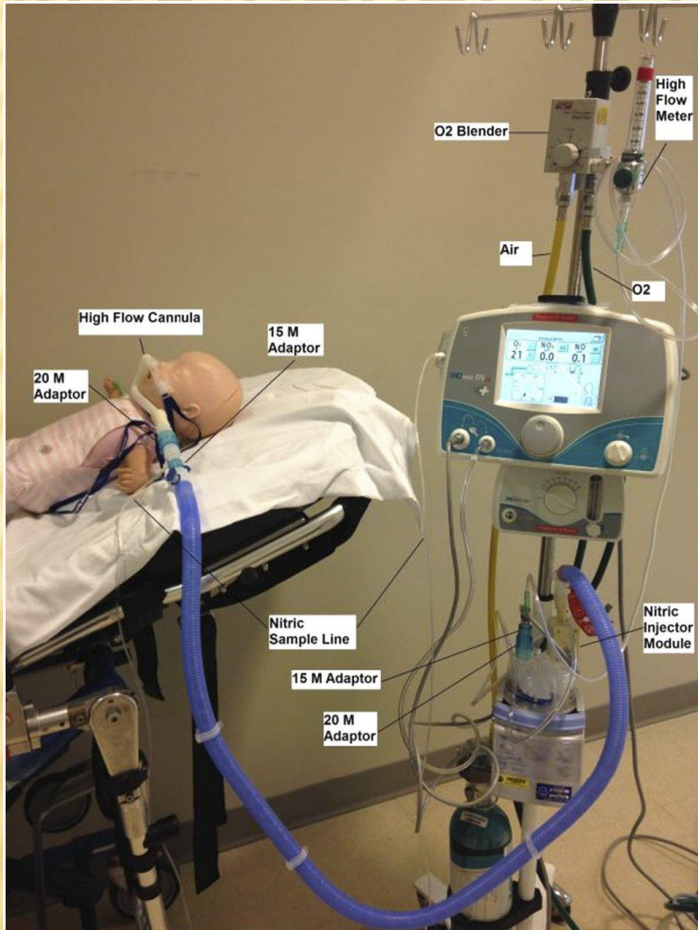





ARABELLA Monitoring Gas Mixer



ARABELLA Universal Generator



ARABELLA Delivery Circuit



ARABELLA Caps



ARABELLA five-leg stand



www.hamilton-medical.com

Manufacturer: HAMILTON MEDICAL AG, Via Nova, CH-7403 Rhodânz, Svizzera, Tel.: (+41) 81 660 60 10, Fax: (+41) 81 660 60 20
 USA: HAMILTON MEDICAL Inc., 505 Edison Way, P.O. Box 30008, Reno, NV 89520, Tel.: (800) HAMILMED 1, Fax: (775) 856 9621
 Great Britain: HAMILTON (G.B.) Limited, Unit 18 Field Farm Business Centre, Loughton, Bicester, Oxon OX6 6EL, Tel.: (0800) 9179803, Fax: 01869 278992
 Germany: HAMILTON Deutschland GmbH, Daimlerweg 5a, D-64283 Darmstadt, Tel.: 06151 66707-0, Fax: 06151 66707-77
 France: HAMILTON France, Parc de Haute Technologie, 1 Rue Georges Besse, Silic N° 18, 92182 ANTONY CEDEX, Tel.: 01 55 59 18 18, Fax: 01 55 59 18 19
 For all other countries, contact Switzerland or our local distributor.

Technical specifications

ARABELLA Monitoring Gas Mixer

Controls

Flow	0 to 10 l/min
Oxygen	21 to 100%

Monitoring

NCPPAP	0 to 12 cmH ₂ O
Oxygen	21 to 100%

Alarms

High pressure	3 cmH ₂ O above set NCPPAP level
Low pressure	2 cmH ₂ O below set NCPPAP level
	Independent zero pressure alarm
High and low Oxygen	±5% of set Oxygen level
Alarm silence	30 s
Internal pop-off valve	150 cmH ₂ O
Safety limit valve and alarm	Terminates flow if pressure exceeds 11 cmH ₂ O (reinitiates gas flow after 3 s)

Gas supply	Pressure difference between air and oxygen
------------	--

Electronic displays

Brightness	Auto-dimming
Pressure resolution	±1 cmH ₂ O
Oxygen resolution	±1%

Pneumatic and electrical supplies

Air/oxygen supplies	207 to 510 kPa (2 to 5 bar; 30 to 75 psi)
Electrical power	110 to 240 V ac, 50/60 Hz, 22 VA

Physical characteristics

Dimensions (W x D x H)	214 x 175 x 145 mm (8.4 x 6.9 x 5.7 in.)
Weight	7.1 kg (15.6 lb)

Environment

Operating temperature	10 to 40 °C at 0 to 75 relH, noncondensing
Storage temperature	-10 to 60 °C at 0 to 75 relH, noncondensing
Atmospheric pressure	700 to 1060 hPa (10 to 15 psi)

Standards

IEC 60601-1/ EN60601-1, IEC 60601-1-2/ EN60601-1-2

ARABELLA Universal Generator

Prongs sizes XL L M, S

ARABELLA Delivery Circuit

Voltages	16, 21, and 28 V
Compatibility of 21 V version	Fisher & Paykel MR600, MR620, MR630, MR700, MR720, and MR730; Hudson RCI 380-88
Compatibility of 16 V version	Hudson RCI 380-90
Compatibility of 28 V version	Marquest SCT2000 and SCT3000

ARABELLA Caps

Cap size 1	Lemon yellow
Cap size 2	Blueberry
Cap size 3	Raspberry
Cap size 4	Lime Green
Cap size 5	Strawberry

ARABELLA five-leg stand

Pole mount for ARABELLA Monitoring Gas Mixer

Note: 1 hPa = 1 mbar = 1 cmH₂O

HAMILTON
MEDICAL
MAKING TECHNOLOGY SERVE MANKIND